

NOTES:

1. Material: UVFS;
2. G - Fine ground surface;
3. All dimensions are in mm;
4. Protective chamfers: 0.3 mm x 45°;
5. Apex angle tolerance: ± 2 arcmin;
6. Pyramid tolerance: ± 1 arcmin;

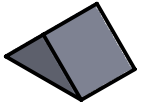

Isometric view 1:2

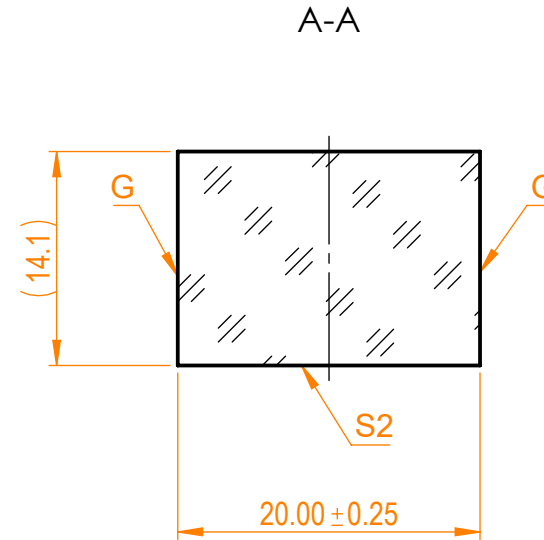
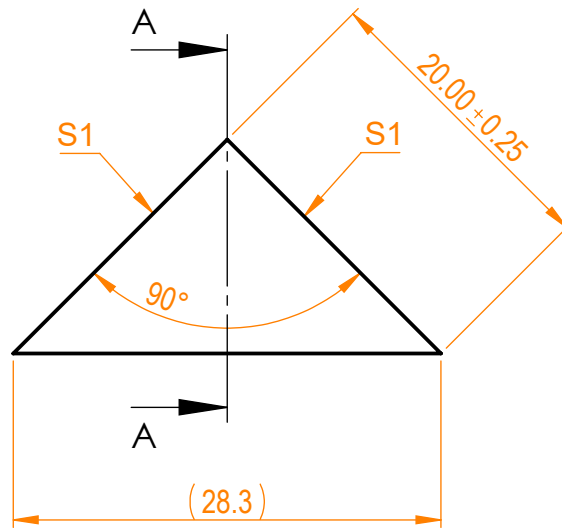

Specifications are subject to change without notice
Dimensions are for reference only

| Parameters | | |
|------------------|--------------------|--------------------|
| | S1 | S2 |
| Shape | Plano | Plano |
| Surface flatness | $\lambda/4$ @633nm | $\lambda/4$ @633nm |
| Surface quality | 40-20 s/d | 40-20 s/d |
| Clear aperture | >80% | >80% |
| Coating | - | - |



RA prism, L=20 mm, T=20 mm

| | | | | | | |
|---|----------|------|------------|-------------|------|-------|
| Proprietary | | Name | Date | Part number | Rev. | Scale |
| The information in this drawing is property of EKSMA Optics. Any reproduction in part or as a whole without the written permission of EKSMA Optics is prohibited. | Approved | A.K. | 2020.12.14 | 330-1202 | A | 2:1 |
| | Drawn | V.S. | 2020.12.14 | | | |

1 2 3 4 5 6

A

A

B

B

C

C

D

D

1 2 3 4 5 6