

**NOTES:**

1. Material: UVFS;
2. G - Fine ground surface;
3. All dimensions are in mm;
4. Protective chamfers: 0.3 mm x 45°;
5. Apex angle tolerance:  $\pm 2$  arcmin;
6. Pyramid tolerance:  $\pm 1$  arcmin;

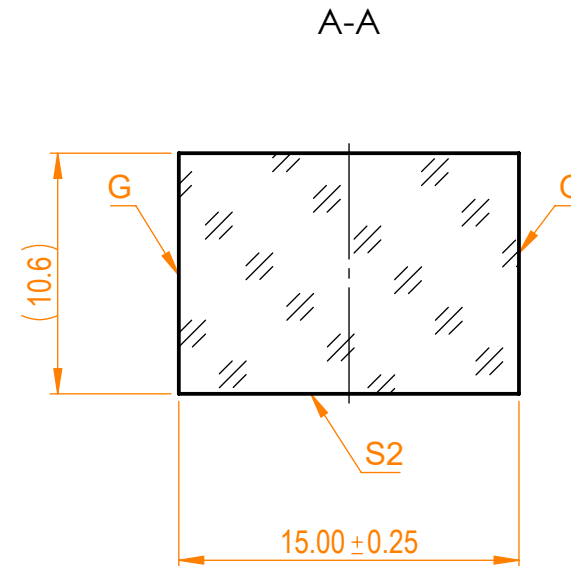

Isometric view 1:2

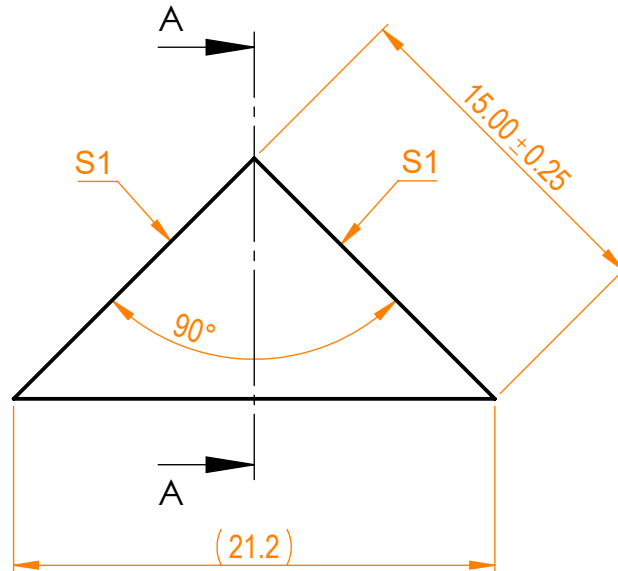

Specifications are subject to change without notice  
Dimensions are for reference only

		Parameters	
		S1	S2
Shape		Plano	Plano
Surface flatness		$\lambda/4$ @633nm	$\lambda/4$ @633nm
Surface quality		40-20 s/d	40-20 s/d
Clear aperture		>80%	>80%
Coating		-	-



RA prism, L=15 mm, T=15 mm

Proprietary	Approved	Name	Date	Part number	Rev.	Scale
The information in this drawing is property of EKSMA Optics. Any reproduction in part or as a whole without the written permission of EKSMA Optics is prohibited.	Approved	A.K.	2020.12.14	330-1152	A	3:1
	Drawn	V.S.	2020.12.14			

1 2 3 4 5 6

A

A

B

B

C

C

D

D

1 2 3 4 5 6