

**NOTES:**

1. Material: UVFS;
2. G - Fine ground surface;
3. All dimensions are in mm;
4. Wedge: <3 min;
5. Protective chamfers: 0.3 mm x 45°;
6. Laser Induced Damage Threshold:
  - > 0.1 J/cm<sup>2</sup> at @355nm, 50Hz, 5.7nsec pulses,
  - > 0.25 J/cm<sup>2</sup> at @1064nm, 50Hz, 11nsec pulses;

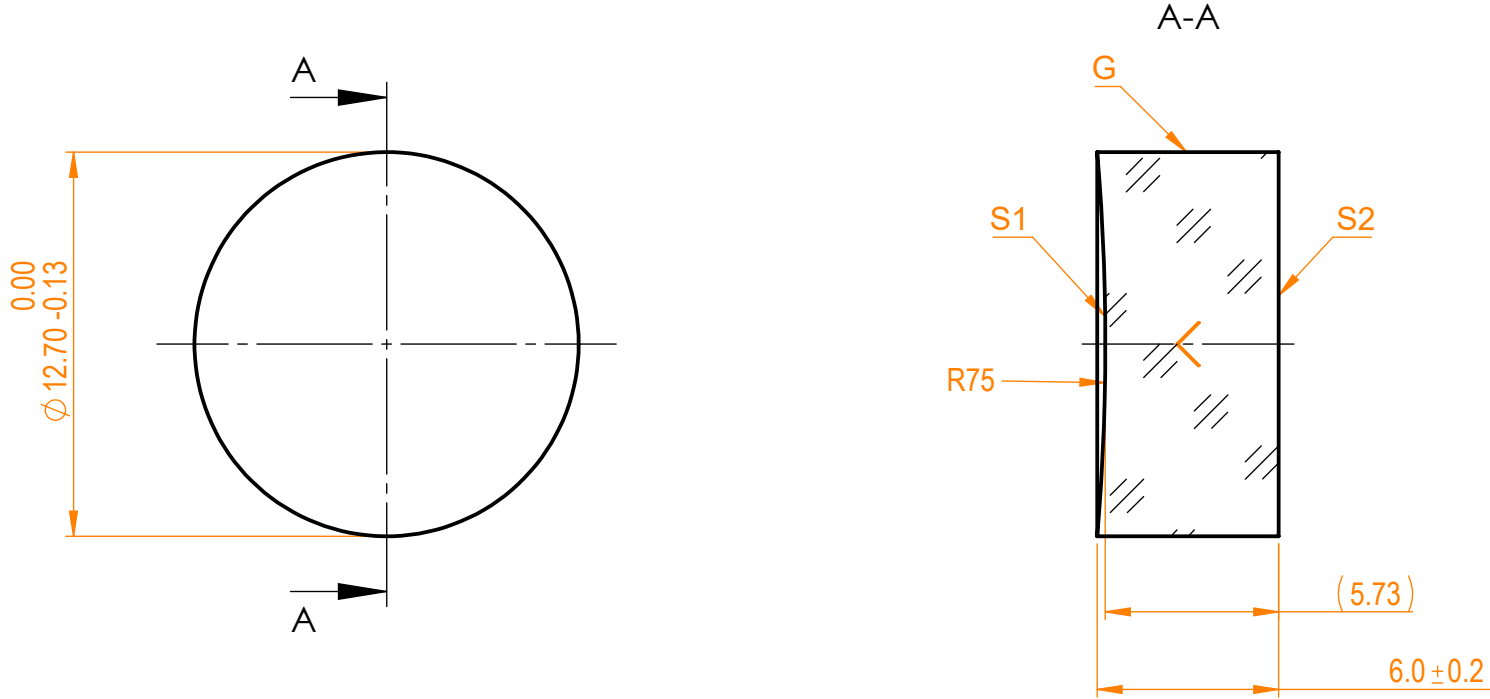

Isometric view 1:1



Specifications are subject to change without notice  
 Dimensions are for reference only

Parameters		S1		S2		UVFS pl/cv mirror, D=12.7 mm, T=6 mm info@eksmaoptics.com www.eksmaoptics.com		Name    Date    Part number    Rev.    Scale						
Shape	Concave	Concave		Plano						A.K.	2020.11.16	091-3115R-75	A	4:1
Radius of curvature	75	75		Infinity										
Surface flatness	λ/10 @633nm	λ/10 @633nm		λ @633nm										
Surface quality	40-20 s/d	40-20 s/d		80-50 s/d										
Clear aperture	>90%	>90%		>90%		V.S.	2020.11.16							
Coating	Protected aluminium Ravg>86%@300nm - IR	Protected aluminium Ravg>86%@300nm - IR		Uncoated										

Proprietary

The information in this drawing is property of EKSMA Optics. Any reproduction in part or as a whole without the written permission of EKSMA Optics is prohibited.

Approved

Drawn