

## PRECISION OPTICAL MOUNTS OF SIDE CONTROL SERIES T

- Adjustment of both angles is controlled from a single side
- Ideal for high density optical schemes
- Fine adjustment screws with 0.25 mm pitch
- Travel range  $\pm 2^\circ$
- Hardened inserts under adjusters
- Original L-shaped flat spring

Precision Optical Mounts of Side Control enable to greatly increase thickness of optical elements as it has a convenient access to the adjustment handles.

L-shaped flat spring of original design provides great stability of the mount's platform. The spring performs two functions: that of a usual spring, and also eliminates polarizing rotation of the platform.

Angular range is  $\pm 2^\circ$  about each of the two orthogonal axes. Precision screws

with pitch of 0.25 mm provide sensitivity of 10 arcsec.

Three M4 tapped holes on the sides of the base and on its back allow a variety of mounting configurations, e.g. horizontal and vertical.

The mount is produced from black anodized aluminium. L-shaped spring is produced from high quality stainless spring steel.

### 840-0120-T

### OBJECTIVE MOUNT

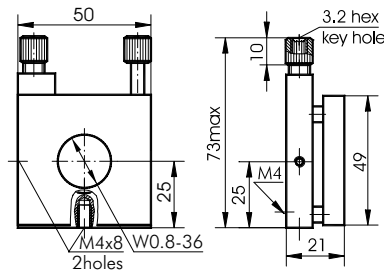

The Objective Mount of Side Control 840-0120-T has W0.8-36 mm aperture and is used for precise adjustment of standard microscope objective lenses and ensures low-cost positioning of a focus point. Also it can be used in the fiber optics.

Code	Weight, kg	Price, EUR
840-0120-T	0.1	89

### 840-0130-T

### BEAMSPLITTERS/OPTICS MOUNT

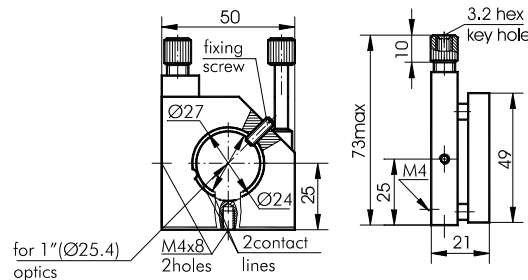

The Beamsplitters/Optics Mount 840-0130-T is designed to adjust beamsplitters measuring  $\varnothing 25$  mm. Fixing screw with a plastic tip clutches a beamsplitter against 2 contact lines. The aperture has a rest-blade around its edge designed to stop optics inside.

Code	Weight, kg	Price, EUR
840-0130-T	0.09	63

### 840-0140-T

### UNIVERSAL MIRROR MOUNT/PLATFORM

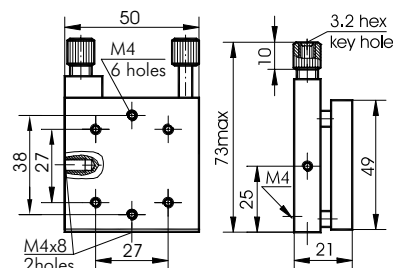

The Universal Mirror Mount/Platform 840-0140-T is suited for precise adjustment of standard mirrors which can be directly bound to it. The Mount may also be used in horizontal position as a tilt table. Then it can be used to align opto-mechanics around two axes.

Code	Weight, kg	Price, EUR
840-0140-T	0.12	69