

**870-0060 COMPACT FINE SCREWS**



870-0060



870-0060-01

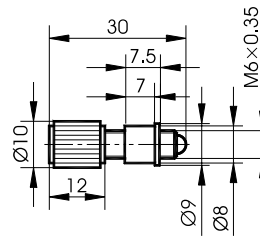

870-0060

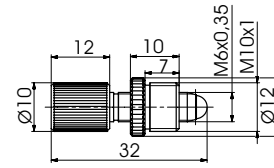

870-0060-01

Compact Fine Screws 870-0060 provide high resolution. A unique design allows smooth adjustment and high repeatability thanks to matched stainless steel screw/brass nut pairs. Using screw/nut matching technology, backlash is in high precision M6x0.35 thread almost eliminated. The combination of metals provides a superior match for both movement and long lifetime. 870-0060 has a mounting diameter of Ø8 mm. The 870-0060-01 has a mounting thread M10x1, or M10x0.5 as an option. A compact knob is made from black anodized aluminium.

**SPECIFICATIONS**

Adjustment screw thread	M6x0.35
Sensitivity	1.3 µm
Nominal travel	8 mm
Axial load capacity	70 N

Code	Weight, kg	Price, EUR
870-0060	0.015	18
870-0060-01	0.015	21



840-0060 with 870-0060 installed

**Complementary Products**

Code	Page
840-0060	8.67

**870-0070 • 870-0071 ADJUSTMENT SCREWS**



870-0070



870-0071

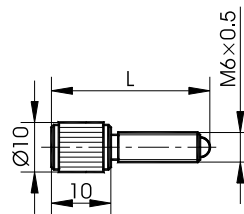

870-0070

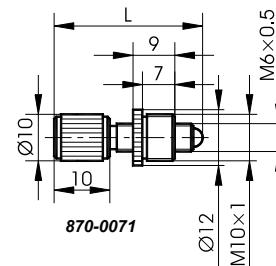

870-0071

Adjustment Screws 870-0070 and 870-0071 are popular for their low cost and miniature size, in applications where rough resolution about 5 µm is enough.

870-0071 consists of M6x0.5 screw and nut with M10x1 mounting thread (M10x0.5 as option).

870-0070 and 870-0071 series screws suite well for optical mount and can be chosen as an option in mounts 840-0040, 850-0095 and others.

**SPECIFICATIONS**

Adjustment screw thread	M6x0.5
Sensitivity	1.5 µm
Axial load capacity	80 N

Code	Travel, mm	L, mm	Weight, kg	Price, EUR
870-0070-08	8	29	0.015	6
870-0071-08	8	29	0.02	10
870-0070-18	18	39	0.025	8
870-0071-18	18	39	0.03	12



840-0036-01



850-0095 with 870-0070-18 installed

**Complementary Products**

Code	Page
850-0095	8.102