

840-0057 MOUNTS WITH HARD SEATS **new**

- Original stabilized L-shaped flat spring
- 1" and 2" optics mounts
- Precise (sensitivity of 3 arcsec and 1 μm)
- Stable, with hard steel or sapphire seats under adjustment screws
- Tilt range of 5° in two orthogonal planes
- Travel range 4 mm
- Vertical mounting on either of two sides
- "Mirror" versions available
- Material: black anodized aluminium



Mounts 840-0057 have 1" (840-0057-1) or 2" (840-0057-2) mounting hole. A fixing screw secures the optics against 2 contact lines, which make 2 contact points. To prevent damage to the optics, the tip of the fixing screw is made of plastic. On one side the edge of the optics stays clear. So you can use the optics close to the edge in schemes where beams are very closely situated to one another. You may order mounts with 2 and 3 adjustment screws.

Each screw has a hardened steel ball tip. It pushes the aluminium platform against a hard seat. This results in increased durability, stability, and fine motion. M6/Ø7.4 mounting/clearance holes are centered against the center of the mounted optics. The platform has an original L-shaped flat spring. It performs two functions: preloading the platform, and reducing its drift. The high tension spring and the thick base of the unit increase its stability. This allowed to eliminate a part of the mount, keeping clear one side of the optics.

Code	840-0057-12 840-0057-13	840-0057-22 840-0057-23
Tilt/tip range	5°	5°
Sensitivity	5(3) arcsec	5(3) arcsec
Travel range	4 mm	4 mm
Sensitivity	1(0.5) μm	1(0.5) μm
Optics diameter	≤ Ø25.4 mm	≤ Ø50.8 mm
Clear aperture	24 mm	45 mm

Examples of codes	Screws
840-0057-13S	3
840-0057-12S	2
840-0057-22SH	2 hex
840-0057-13SPH	3 hex

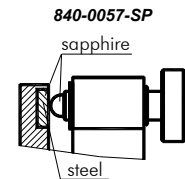

840-0057-S
A screw pushes via a seat of hardened stainless steel or sapphire.

"S" – a screw pushes via a seat of hardened stainless steel
 "SP" – a screw pushes via a seat of sapphire
 "M" – "Mirror" version
 "H" – hex screws. Removable hex knobs are available separately.

Code	Optics size	Screws	Weight, kg	Price, EUR
840-0057-12	1"	2	0.09	67
840-0057-13	1"	3	0.10	75
840-0057-22	2"	2	0.14	99
840-0057-23	2"	3	0.15	115

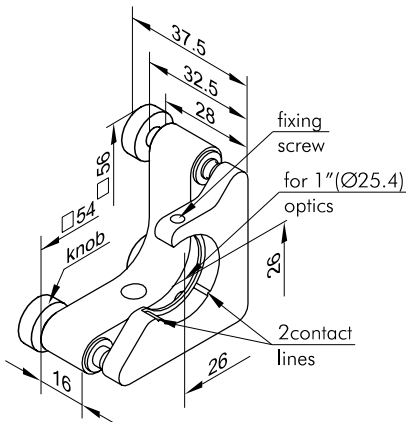

840-0057-13S
uses three Fine Screws 870-0080 (with knobs).
840-0057-13SH uses three Fine Screws 870-0080 (without knobs) to reduce risk of tampering (hex key included).

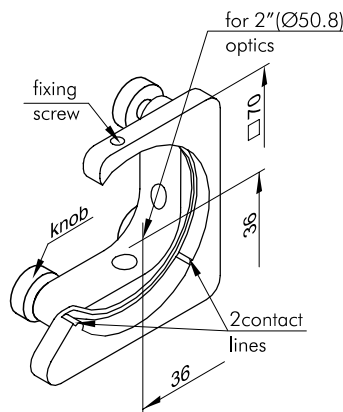

840-0057-23S
uses three Fine Screws 870-0080 (with knobs).
840-0057-23SH uses three Fine Screws 870-0080 to reduce risk of tampering (hex key included).

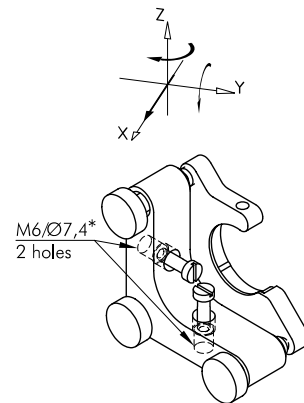

* slide M4(8-32) screws through combined M6/Ø7.4 mounting/clearance holes to mount the unit immediately to M4(8-32) holes, or mount the unit directly on any M6 tip

OPTICAL TABLES
 BRACKETS & RAILS
 BASE MOUNTS & ACCESSORIES
 OPTICAL MOUNTS
 OPTICAL POSITIONERS
 BASE POSITIONERS
 TRANSLATION & ROTATION STAGES
 ADJUSTMENT SCREWS
 MOTORIZED POSITIONERS