

765 • 766 OPTICAL TABLE SUPPORTS



- Convenient sizes
- Optimal height
- Multipurpose in use
- Handy assembling

SPECIFICATIONS

Natural frequency	3-5 Hz
Natural frequency pressure-relieved approx.	8 Hz
Max. load per 4 isolators	
AP-200	195 kg (max pressure 5 bar)
AP-500	540 kg (max pressure 5 bar)
AP-1000	840 kg (max pressure 6 bar)
AR	1500 kg
AS	3000 kg

Optical Table Supports are primarily designed for the Honeycomb Table Tops (720–740). Table Supports are produced from steel tubes two **100 mm** square section, in decorative black coating and contain two “I” type supports, bound by a cross-beam.

Optical Table Supports perfectly suit other types of optical plates and other equipment as well. This is possible because plates are not fastened – they are just laid on top of the supports.

On request we produce table supports of any size, design, and of greater sturdiness.

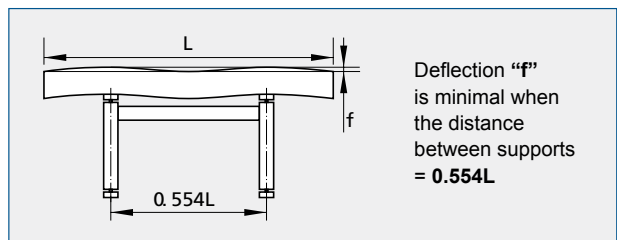
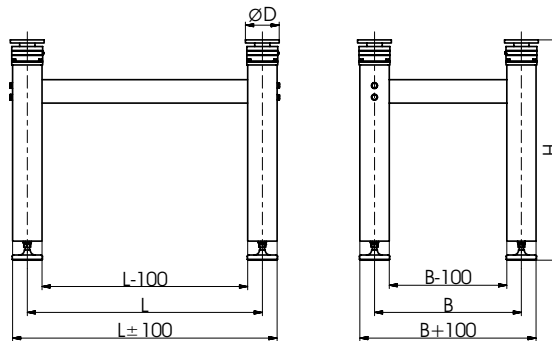

Optical Table Support 765/766 with Honeycomb Table Tops 720/730/740

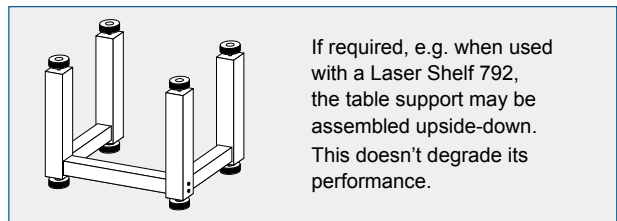

ORDERING INFORMATION

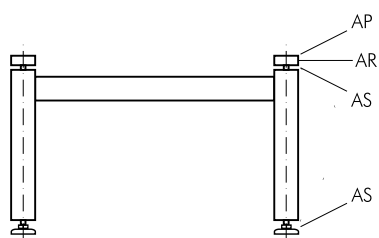

Type of **upper** leveling elements of optical table support can be chosen from **AS**, **AR** or **AP** (see descriptions below). **Bottom** elements on optical table support are of type **AS**.

Default choice for **upper** elements of **765/766** is **AR** rubber leveling elements.

Example:

765-0507-AR – table support sized **500 × 500 × 700 mm** (Height (h) × Width (b) × Length (l)) with **4** pieces of **AR** leveling elements on top and **4** pieces of **AS** leveling element at the bottom.

For other types of leveling elements please append element abbreviation to product code.

Examples:

766-0512-AS – size **600 × 500 × 1200 mm** (Height (h) × Width (b) × Length (l)), type of leveling elements – **AS** (8 pieces, **4** on top and **4** at the bottom).

766-6518-AP-200 – size **600 × 650 × 1800 mm** (Height (h) × Width (b) × Length (l)), with **4** pieces of leveling elements type **AP-200** on top and **4** pieces of leveling elements type **AS** at the bottom.

AR Rubber Leveling Element



Rubber leveling element (AR) ensures sufficient vibration isolation.

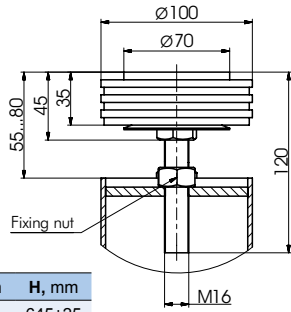

Code	B, mm	L, mm	H, mm
765-0507-AR	500	700	645±25
766-0507-AR	500	700	745±25
765-0512-AR	500	1200	645±25
766-0512-AR	500	1200	745±25
765-6512-AR	650	1200	645±25
766-6512-AR	650	1200	745±25
765-6518-AR	650	1800	645±25
766-6518-AR	650	1800	745±25
765-6522-AR	650	2200	645±25
766-6522-AR	650	2200	745±25
765-0812-AR	800	1200	645±25
766-0812-AR	800	1200	745±25

AS Solid Leveling Element



Solid leveling element (AS) is used, when no damping is needed.

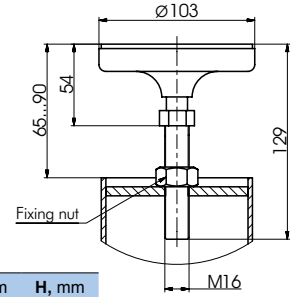

Code	B, mm	L, mm	H, mm
765-0507-AS	500	700	655±25
766-0507-AS	500	700	755±25
765-0512-AS	500	1200	655±25
766-0512-AS	500	1200	755±25
765-6512-AS	650	1200	655±25
766-6512-AS	650	1200	755±25
765-6518-AS	650	1800	655±25
766-6518-AS	650	1800	755±25
765-6522-AS	650	2200	655±25
766-6522-AS	650	2200	755±25
765-0812-AS	800	1200	655±25
766-0812-AS	800	1200	755±25

AP Passive Air Leveling Vibration Isolator



The Passive air leveling vibration isolator AP is a low height, low stiffness air spring isolator mount suitable for both passive and dynamic applications where a support natural frequency as low as 3–5 Hz is required.

Typical passive applications include the protection of vibration sensitive equipment such as co-ordinate measuring machines, metrology inspection devices, isolation tables and electron microscopes.

The AP Isolator elastomer body made of CR grade with high elasticity oil resistant and non-aging. Pressure and bottom plates made of galvanized steel.

Inflation is either through the 'moulded in' standard tyre valve or by connection to a permanent air supply.

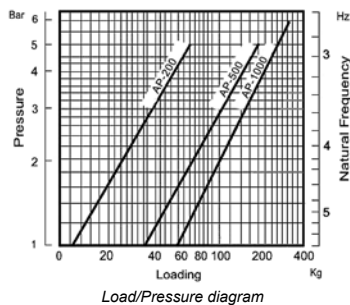
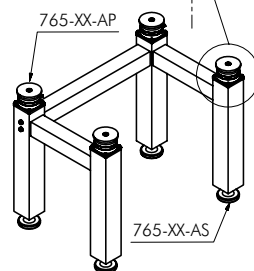
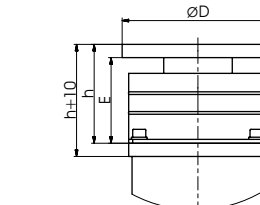
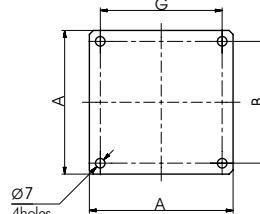
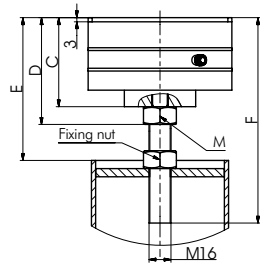

Model	B, mm	L, mm	H, mm	D, mm
765-0507-AP-200	500	700	665±15	85
765-0507-AP-500	500	700	665±15	115
765-0507-AP-1000	500	700	690±15	140
766-0507-AP-200	500	700	765±15	85
766-0507-AP-500	500	700	765±15	115
766-0507-AP-1000	500	700	790±15	140
765-0512-AP-200	500	1200	665±15	85
765-0512-AP-500	500	1200	665±15	115
765-0512-AP-1000	500	1200	690±15	140
766-0512-AP-200	500	1200	765±15	85
766-0512-AP-500	500	1200	765±15	115
766-0512-AP-1000	500	1200	790±15	140
765-6512-AP-200	650	1200	665±15	85
765-6512-AP-500	650	1200	665±15	115
765-6512-AP-1000	650	1200	690±15	140
766-6512-AP-200	650	1200	765±15	85
766-6512-AP-500	650	1200	765±15	115
766-6512-AP-1000	650	1200	790±15	140
765-6518-AP-200	650	1800	665±15	85
765-6518-AP-500	650	1800	665±15	115
766-6518-AP-200	650	1800	690±15	140
766-6518-AP-500	650	1800	765±15	85
766-6518-AP-1000	650	1800	765±15	115
766-6518-AP-1000	650	1800	790±15	140
765-6522-AP-200	650	2200	665±15	85
765-6522-AP-500	650	2200	665±15	115
766-6522-AP-1000	650	2200	690±15	140
766-6522-AP-200	650	2200	765±15	85
766-6522-AP-500	650	2200	765±15	115
766-6522-AP-1000	650	2200	790±15	140
765-0812-AP-200	800	1200	665±15	85
765-0812-AP-500	800	1200	665±15	115
766-0812-AP-1000	800	1200	690±15	140
766-0812-AP-200	800	1200	765±15	85
766-0812-AP-300	800	1200	765±15	115
766-0812-AP-1000	800	1200	790±15	140